

TOTAL EXTENT (AS PER DOCUMENT) : 44960 SQ.M
ROAD AREA : 2186 SQ.M
PARK AREA : 4568 SQ.M
NO. OF PLOTS (COMMERCIAL) : 3 Nos.

NOTE:

- ROAD AREA WAS HANDED OVER TO THE CMDA VIDE GIFT DEED DOCUMENT NO.6085/2021, DATED:20.04.2021, @ SRO GUDUVANCHERI
- PARK AREA WAS HANDED OVER TO THE CMDA VIDE GIFT DEED DOCUMENT NO.6469/2021, DATED:26.04.2021, @ SRO GUDUVANCHERI

NOTE:

IN THE CSO MEETING HELD ON 13.05.2019 IT WAS DECIDED TO ACCEPT PROPOSED LOCATION OF OSR IN THE ASI PROHIBITED NOTIFIED AREA SUBJECT TO TAKING POSSESSION OF THIS OSR AREA BY CMDA ITSELF AND COULD BE UTILIZED ALONG WITH THE LANDSCAPING AREA PROPOSED IN THE (NMBT) NEW MOFUSSIL BUS TERMINUS AT KILAMBAKKAM SO THAT A SEPARATE PUBLIC ACCESS TO THE OSR WOULD NOT BE NECESSARY.

CONDITION:

DR RULE NO: 29 (B)

THE COST OF LAYING IMPROVEMENTS TO THE SYSTEMS IN RESPECT OF ROAD, WATER SUPPLY, SEWERAGE, DRAINAGE OR ELECTRIC POWER SUPPLY THAT MAY BE REQUIRED AS ASSESSED BY THE COMPETENT AUTHORITY, SHALL BE BORNE BY THE APPLICANT.

LEGEND:

- ▬ SITE BOUNDARY
- ▬ ROADS GIFTED TO CMDA
- ▬ EXISTING ROAD
- ▬ PARK

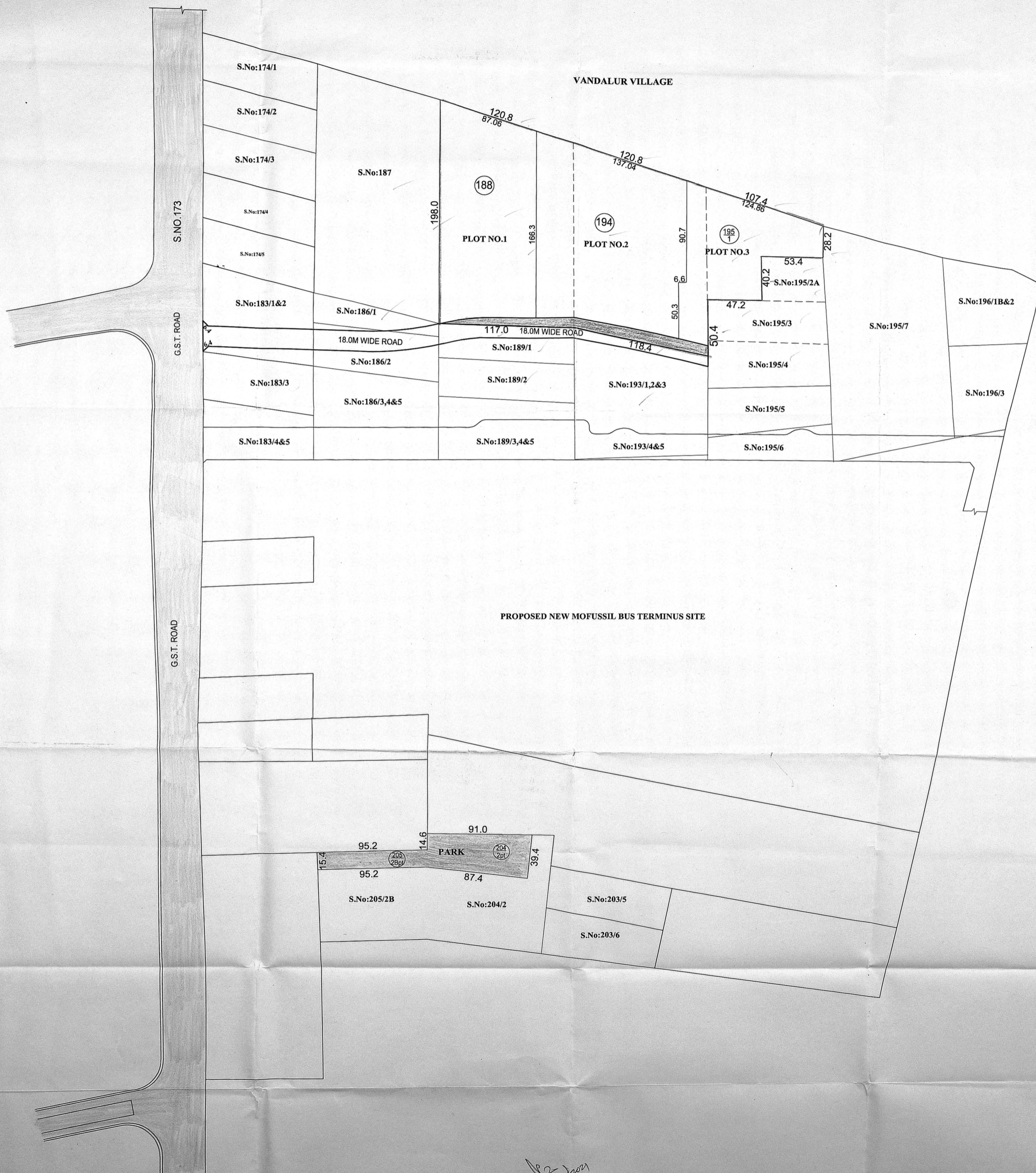

PREPARED BY

P.A.I.

13/07/2021

KATTANKOLATHUR PANCHAYAT UNION
SUB-DIVISION OF PLOTS FOR COMMERCIAL USE COMPRISED IN NEW S.Nos. 188, 194, 195/1, 204/2pt AND 205/2Bpt (OLD S.Nos.188/1,2,3,4,5, 194/1,2,3,4,5, 195/1,2B, 204/4pt,6pt, 205/4pt) OF KILAMBAKKAM VILLAGE.

SCALE:1:1500 (ALL MEASUREMENTS ARE IN METRE)

CONDITION:
 THE SUB DIVISION APPROVED IS VALID SUBJECT TO OBTAINING SANCTION FROM THE LOCAL BODY CONCERNED.

P.P.D NO : 103
 L.O 2021
APPROVED

VIDE LETTER NO : L1/6026/2019
 DATE : 16/07/2021

FOR MEMBER SECRETARY
 CHENNAI METROPOLITAN
 DEVELOPMENT AUTHORITY

